



LOCATION

- Situated at the foot of the Jura Mountains, facing the Mont Blanc
- In the heart of a 98 acre private estate
- 10 minutes away from Geneva International Airport and Palexpo

ACCOMMODATION

50 bedrooms of different types :

- 12 Superior rooms
- 4 Superior rooms with mountain view
- 24 Deluxe rooms
- 4 Corner Deluxe rooms
- 4 Lodges Jacuzzi
- 2 Suites

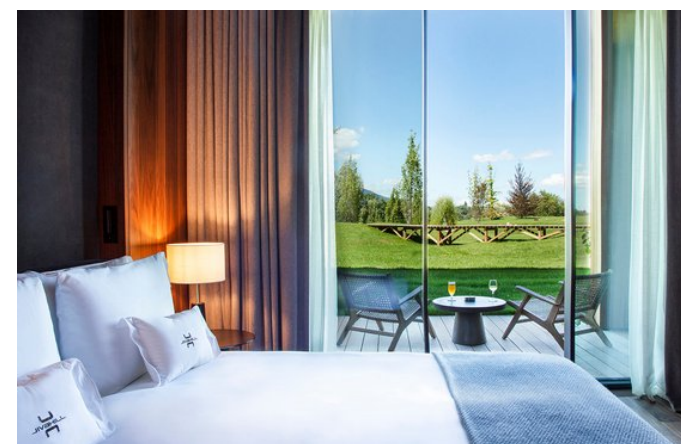

RESTAURANTS

- The Jiva restaurant
French cuisine
- The Jardin restaurant
Italian cuisine



SPA

- 1 Heated outdoor swimming pool
- 1 Heated indoor swimming pool
- Sauna, Hammam, Jacuzzi, Nordic Spa
- 1 Fitness room
- 5 massage rooms



ACTIVITIES

- 9 holes 18 tees golf course
- Game room
- Movie Theater
- Waterskiing lake
- Tennis courts and fitness trail





SEMINARS & GROUPS

- 1 Voltaire
- 2 The Lounge
- 3 Villa du Lac
- 4 Hangar
- 5 Hangar helico

The Lounge



The Voltaire



The Villa du Lac

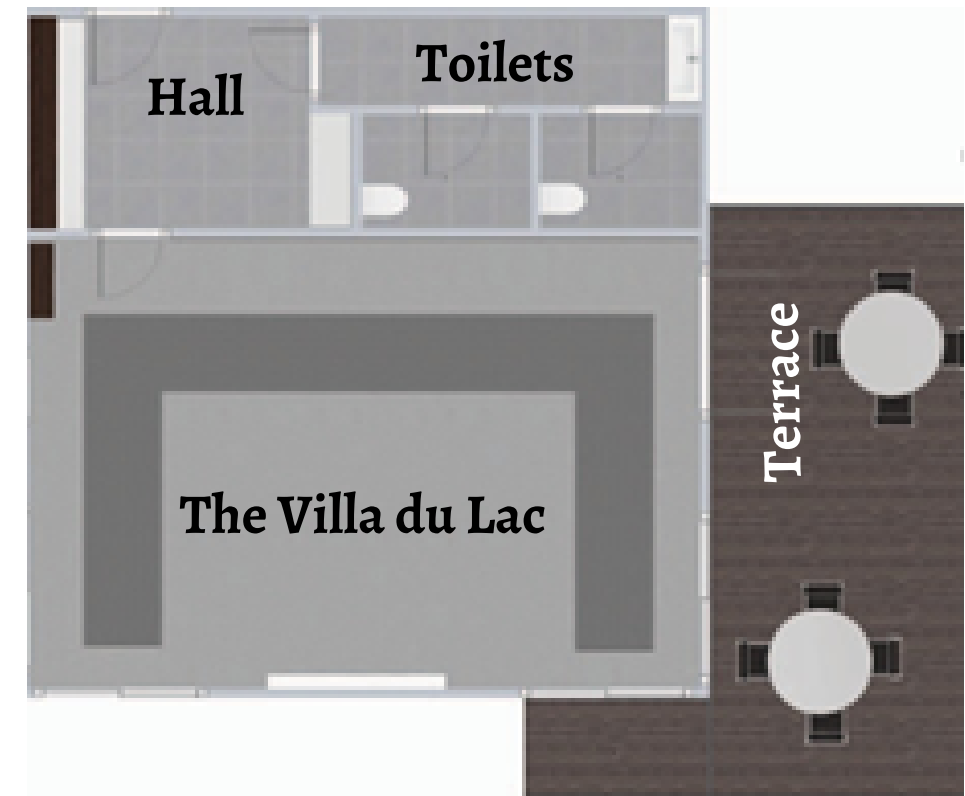

The Hangar

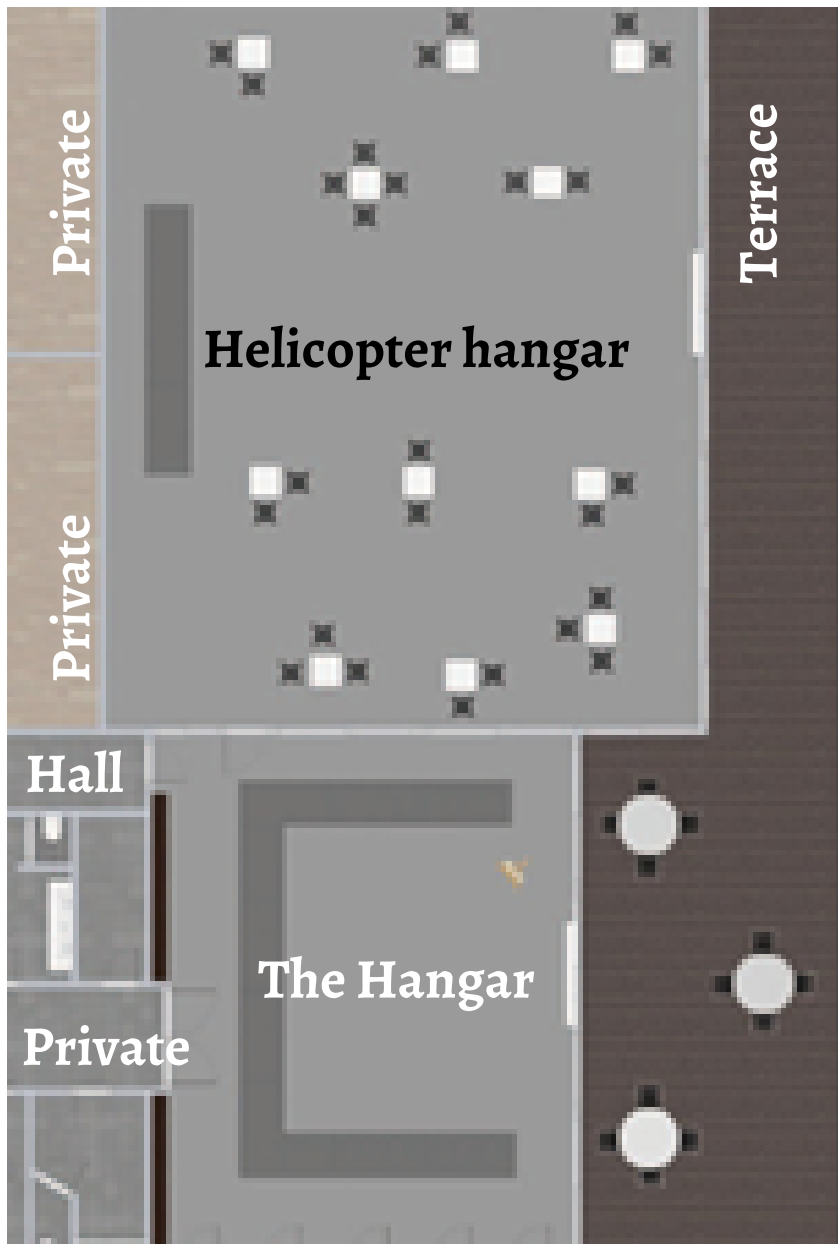

Heliport

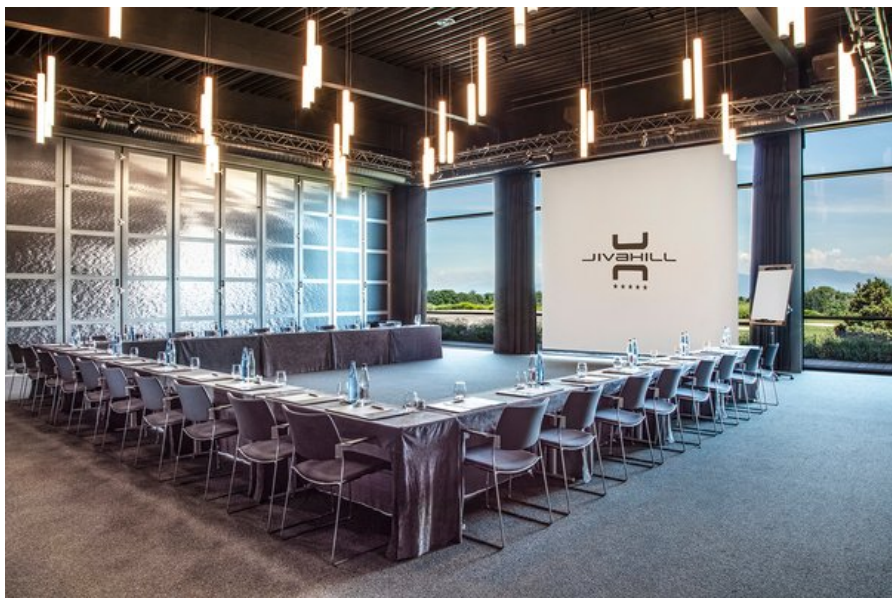

MEETING INFORMATION

	SALON	Dimensions	Conférence	U	Classe	Théâtre	Cocktail	Banquet
1	Salon Voltaire	40 m ²	16	-	-	-	-	-
2	Le Lounge	60 m ²	14	-	-	-	30	-
3	La Villa du Lac	62 m ²	24	18	40	50	50	-
4	Le Hangar	120 m ²	32	24	70	90	90	-
5	Le Hangar Hélico	180 m ²	40	32	90	110	120	80
6	Les Hangars	300 m ²	-	-	110	110	140	130

